



June 2016

President's Message

I am writing this final president's message from a very cool Alberta. It is almost noon and it is only a chilly five degrees. Gardeners here have been dashing around covering their annuals or even bringing them indoors. It was a bit surreal to see the snow laying on the ground these last few days. On the coast it is easy to forget how fortunate we are to live in such a wonderful gardening climate.

Thank you to the current executive for their enthusiasm and support. I have truly enjoyed working with each and every one of them. A big thanks also to those who are continuing to give a little extra by continuing to serve the club in so many ways. At our May general meeting it was lovely to see the many people who so readily step forward to make the NRS such a great club to belong to.

Do join us for the year-end wind up potluck, barbecue and social on Saturday, June 4th at June and John's lovely home and garden in Bowser. Grilled Pork loin slices & chicken wings will be available. This year you'll have a chance to meet some of the executive members from other Rhodo clubs as well as Geoff Ball & his wife Candice from Milner Gardens & Woodland.

Kind regards to you all,
Chris

EXECUTIVE

President	Chris Southwick	390-3415
Vice President	Brenda Lewis	751-3639
Secretary	Ann Beamish	758-2574
Treasurer	Krystyna Sosulski	729-0948
Directors	Glenda Barr	390-2822
	Craig Clarke	390-4090
	Susan Lightburn	468-7516
	Gayle McRae	758-7589
	Art Lightburn	468-7516
	Sandra Dorman	390-0136

COMMITTEES

Advertising	Jan Moles	
Library	Ann Beamish	758-2574
Newsletter	Kathryn Grant	585-2706
Membership	Sandra Dorman	390-0136
Program	Art Lightburn	468-7516
Raffle	Ann Davey & Val Harvey	
Social	Susan Lightburn	468-7516
Bargain Table	Reinhold Gorgosilich	758-6533
Website	Craig Clarke	390-4090
Sunshine	Edith Higgins	390-9340
Bus Tour	John Deniseger & June Bouchard	
Truss Show	Doug Blenkarn	
Spring Sale	Ann Beamish	

Nanaimo Rhododendron Society
Box 241, #101-5170 Dunster Road
Nanaimo, BC V9T 6M4
Website: nanaimo.rhodos.ca
email: nanaimo@rhodos.ca

Next Meeting

Saturday, Jun. 4, 4 PM June & John

Spring Windup BBQ & potluck

Twigs and Stems



Milner Gardens

Open daily 10 – 5 until Sept. 5th

Mount Arrowsmith Biosphere
Region Course Sat May 28 at Milner

[Click here](#) for details

Closing-out sale at Nanaimo Dig This

Nanaimo Rhododendron Society Calendar

Our regular monthly meetings normally begin at 7:30 pm on the 2nd Thursday of the month at Beban Park Social Centre. Executive meetings begin at 2:00 pm on the 3rd Thursday of the month.

August 25, 2016 3PM exec meeting hosted by Allen & Gayle

Windup party June 4th

When: Starts at around 4 pm on June 4th

Where: June and John's place at 4555 Thompson Clarke Drive East, Bowser. We're about 45 minutes from Woodgrove Mall. Follow Hwy 19 north, turn right at exit 75 (Horne Lake Rd). Make your way down to Hwy 19A, turn left and continue through Qualicum Bay and Bowser. Turn right on Jamieson Rd; cross the railway track; turn right on Thompson Clarke East.



You may wish to consider carpooling.

What to Bring:

Please bring your own plates, cutlery and a chair if you can. For the potluck, bring your choice of appy, salad or dessert. The club will be providing chicken wings and grilled pork tenderloin slices. There will be a BBQ available for those who wish to use it.

What should we call our newsletter?? Voting will take place at the June 4 windup

At our January meeting there were several suggestions and more have come since:

Rhodo Rooter, Rhodo Buzz, Rhodo Rhapsody, Rhodo Holler, Truss Talk, Rhotomentum, Rhodo Ravin, The Rhodophile, Rhodo file, Ravin Rhodo.

Send your idea to President Chris; she is conducting a vote at the June wind-up to choose the winning name.

.....

Anonymous: *Autocorrect has become my worst enema*

NANAIMO RHODODENDRON SOCIETY

Class	Prize	Plant	Winner	Correction
Red hybrid	1 st	Lem's Storm Cloud	Ann & Dick Beamish	
	2 nd	Wild Affair	Ann & Dick Beamish	
	2 nd	Burnaby Centennial	Ann & Dick Beamish	
	3 rd	Halfdam Lem	John Deniseger & June Bouchard	
Blotch/flare hybrid	1 st	Phyllis Korn	John Deniseger & June Bouchard	
	2 nd	Captain Bob	Ann & Dick Beamish	
	2 nd	Sugar & Spice	Jan Moles	
	3 rd	Mrs Furnivall's Daughter	Ann & Dick Beamish	
Lax truss	1 st	Ruby Hart	Art & Susan Lightburn	
	2 nd	Carmen	Chris Southwick	
	3 rd	Egret	Chris Southwick	
	3 rd	Pacific Sunrise	Art & Susan Lightburn	
Pink hybrid	1 st	Britton Hill*	Ann & Dick Beamish	Red
	2 nd	Reina	Ann & Dick Beamish	
	2 nd	Bambino	Ann & Dick Beamish	
	3 rd	Creole Belle	Ann & Dick Beamish	
White hybrid	1 st	Senator Jackson	Ann Davey	
	2 nd	Snow Queen	Ann & Dick Beamish	
	3 rd	Helene Schiffner	Ann & Dick Beamish	
Salmon/Orange	1 st	Medusa	Art & Susan Lightburn	
	2 nd	Honey Butter	Chris Southwick	
	3 rd	Lem's Best Orange	Ann & Dick Beamish	
Purple/blue	1 st	Black Widow	Ann & Dick Beamish	
	2 nd	Elsie Watson	Allen & Gaylle McRae	
	2 nd	G. W. Evans	Ann & Dick Beamish	
	2 nd	Orchid Bouquet	Ann & Dick Beamish	
	3 rd	Anna Kruschke	Ann & Dick Beamish	
Yellow	1 st	Ann Triplet	Val Harvey	
	2 nd	Mindy's Love	Ann & Dick Beamish	
	3 rd	Yellow Petticoats	Art & Susan Lightburn	
Best Scented	1 st	Snow Queen	Craig & Joyce Clarke	
	2 nd	<i>R.edgeworthii</i>	John Deniseger & June Bouchard	
	3 rd	Elsie Frye	Chris Southwick	
Hammerhead	1 st	Horizon Monarch	Gerry Moore	
	2 nd	Nascelle	Ann & Dick Beamish	
	3 rd	Yeti	Craig & Joyce Clarke	
	3 rd	Unknown	Jan Moles	
Alpine/dwarf	1 st	<i>R.campylogynum</i>	Chris Southwick	
	2 nd	<i>R. hanceanum</i> 'Rowallane'	Art & Susan Lightburn	
	3 rd	<i>R.diversipilosum</i> 'Milky Way' *	Art & Susan Lightburn	lepidote
Elepidote species	1 st	<i>R.orbiculare</i>	Ann Davey	
	2 nd	<i>R.degronianum</i>	Art & Susan Lightburn	
	3 rd	<i>R.roxianum oreonastes</i>	Art & Susan Lightburn	
Lepidote Species	1 st	<i>R.augustinii</i>	Val Harvey	
	2 nd	<i>R. menziesii purpureum</i> *	Chris Southwick	elepidote
	3 rd	<i>R.diversipilosum</i> 'Milky Way'	Chris Southwick	
Azalea	1 st	Irene Koster	Allen & Gaylle McRae	
	Truss or spray	Glowing Embers	John Deniseger & June Bouchard	
	3 rd	<i>atlanticum</i>	Chris Southwick	
	3 rd	<i>kiusianum</i> Komo Kulshan	Art & Susan Lightburn	
Foliage	1 st	<i>mallotum</i>	Art & Susan Lightburn	
	2 nd	<i>insigne</i>	Art & Susan Lightburn	
	2 nd	<i>Fabia x bureavii</i>	Art & Susan Lightburn	
	3 rd	<i>R.diversipilosum</i>	Chris Southwick	

*misclassified.

NANAIMO RHODODENDRON SOCIETY

Trophies awarded:

Popular Choice Trophy	1 st R 'Black Widow'	Ann & Dick Beamish	
Best of Show Trophy	1 st R 'Black Widow'	Ann & Dick Beamish	
Hammerhead Trophy	1 st R 'Horizon Monarch'	Gerry Moore	
Best Scented Trophy	1 st R 'Snow Queen'	Craig & Joyce Clarke	
Paul Trophy	Cumulative Points	Ann & Dick Beamish	

Good participation with 209 entries submitted by 20 members...thanks to the many who helped make this show and sale a success. *Doug Blenkarn.*

Raffle at the Show and Sale

Our annual Show and Sale Raffle was very successful this year bringing in \$300. **Many thanks to all of our donors** this year. Our club greatly appreciates your support.

Here are the winners for 2016:

- 1.Lilian Peters - won a Fir tree , a Geranium, and a Salix from **Alba Plants**
- 2.Gail Hudson - R. 'Paprika Spiced' from **Victoria Rhodo Club**
- 3.Jan Moles -- Verbena from **Garden Lore**
- 4.Craig Clarke--Fern from **Fern Garden**
5. Stanley Peters-Day Lily from **Island Passions**
- 6.Nick Padow--Azalea from **Finley's Rhododendrons**
- 7.Barb Ure-R.Blue from **Rhodo Mania**
- 8.Jack McNeil-Scarf from **Cowichan Rhodo club**
9. Rosie Wright-Peony from **Barepoint Gardener**
10. Margaret Graham-Maple Tree from **Mayo Creek**



Gaylle McRae [lady with the hat with help from Allen]

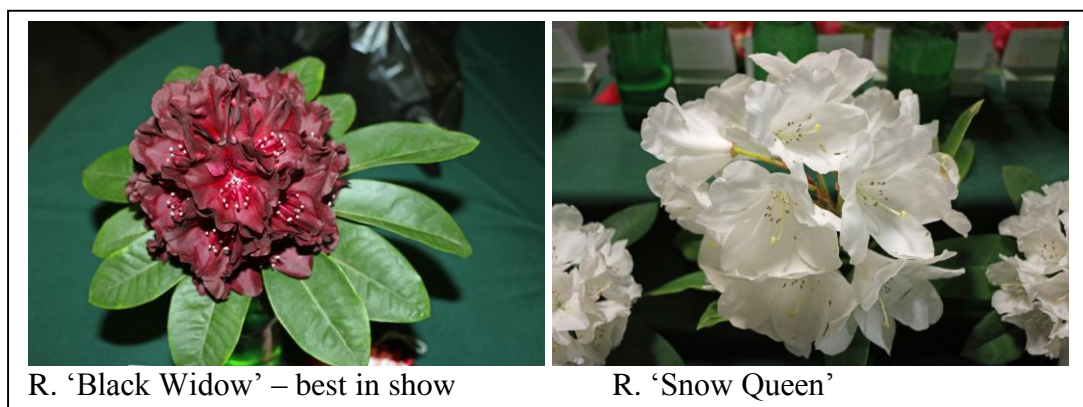

R. 'Black Widow' – best in show

R. 'Snow Queen'



Jean Rhodes with R. 'Captain Bob' - photo by Sue Klapwijk.

Captain Bob was selected by Jean's late husband Bob who grew seed from a cross [*'Red Cloud'* × *'Gypsy King'*] made by the late Merle Cisney. It is not registered.



R. 'Yeti' hammerhead. photo by Craig

NANAIMO RHODODENDRON SOCIETY
Minutes of Annual General Meeting - May 12, 2016

The Annual General Meeting of the Nanaimo Rhododendron Society commenced at 19:35 chaired by President, Chris Southwick with 37 people in attendance.

1. Welcome everyone. President Chris Southwick welcomed guests including Donna Watson one of the founding members.
2. President's report Chris noted the two plants for the silent auction proceeds going to Nepal, bidding will close at 21:00.
 - a. The show and sale netted \$2087.74
 - b. The Bus Tour \$200 with a thank you to John and June for organizing the tour.
3. ELECTION OF EXECUTIVE
 - All members have been canvassed to determine interest in serving on the executive.
 - Chris Southwick commenced the election calling each position each time to determine candidates with the following outcome
 - President: Allen McRae
 - Past President: Chris Southwick
 - Vice President: Art Lightburn
 - Treasurer: Gayle McRae
 - Secretary: Ann Beamish
 - Members at Large: Susan Lightburn
Craig Clarke
Glenda Barr
Dick Beamish
 - Program Director: Doug Kitts
 - Library: Ann Beamish
 - Membership: Krystyna Sosulski
 - Advertising: Gerry Moore and Jan Moles
 - Newsletter: Kathryn Grant/June Bouchard/John Deniseger
 - Raffle: Anne Davey and Val Harvey
 - Social: Susan Lightburn
 - Sunshine: Edith Higgins
 - Website: Craig Clarke
4. Meeting continued after a break and raffle prizes, followed by two outstanding presentations by John Deniseger and by Garth Wedemire.
5. Year-end wind-up will be at June Bouchard and John Deniseger's home in Bowser June 4, 2016 beginning at 4 pm.

.....
Growgreen Guide to Eco-friendly Lawns and Gardens

www.growgreenguide.ca is the result of a collaboration between Metro Vancouver & UBC Botanical Garden. It has tips on water use, healthy soil, composting, creating habitat for birds & pollinators, tackling invasives, etc.

NANAIMO RHODODENDRON SOCIETY

Open House for Rhododendron Species Project at Milner Gardens & Woodland May 17, 2016.



The ground is being prepared...

Vancouver Island University's Milner Gardens & Woodland and The District 1 Vancouver Island chapters of the American Rhododendron Society are excited to be partnering to create a Rhododendron Species Garden in this area over the next few years.

for conservation

Preserving the old growth trees that were left after this area was logged years ago, this garden will highlight the tremendous diversity found within the genus *Rhododendron*, while contributing to the conservation of species threatened by habitat loss in the wild.

for education

Featuring the parent species of many of the heritage hybrid rhododendrons already here, the species garden will show visitors how plants in their home gardens are related to wild species. It will also provide a valuable opportunity for students from Vancouver Island University's Horticulture Technician program to understand how new hybrid species are developed.

for inspiration

Imagine: A world of rhododendrons from the slopes of the Himalayas, the mountains of eastern Europe, and across North America, including species only recently introduced to horticulture, all nestled into this serene woodland setting.

Stay tuned to find out how you can support this new garden.



Interpretative sign at entrance to new rhododendron species garden at Milner Gardens & Woodland.



Upper left: large turnout of members; upper right: volunteer table. Lower: panoramic view looking north showing paths and temporary irrigation. Photos by Craig.

NANAIMO RHODODENDRON SOCIETY

Open House at Milner Gardens (cont.)

There was a great turnout of club members from as far away as Campbell River and Victoria for the private viewing on May 17th to see the progress to date on the new species garden. Geoff Ball, John Deniseger & Art Lightburn described the plans and answered questions. Volunteers are needed to help with carpentry and gardening on the project.

We also took the opportunity to experience the new viewing platform.



*Official opening of viewing platform May 6th.
(l-rt): Nancy Twynam, Chair, MG&W Society;
Noel Burnham, on behalf of the volunteers;
and Dr. Ralph Nilson, President & Vice-Chancellor, VIU.
Photos by Craig.*

Members on viewing platform, May 17th



A stroll through the rhododendrons. Photos by Craig

[Click here](#) for an online booklet about the existing rhododendron collection at Milner Gardens & Woodland.

Did you know that Glin Castle in Ireland, Veronica Milner's former residence, is for sale? **[Click here](#)** for details.

NANAIMO RHODODENDRON SOCIETY

Allelopathy in *Kalmias* by Diana Walker

I read with interest the section on *Kalmia latifolia*; however, there is no mention in this particular article that *Kalmias* can be allelopathic in certain areas. I quote from the book "Kalmia Mountain Laurel and Related Species" by Richard A. Jaynes, as follows:

"Allelopathy is the growth inhibition of one plant by another. A long and well-known example is the growth inhibition effect of black walnut (*Juglans nigra*) trees on several plants, including tomatoes (*Lycopersicon*) and rhododendrons. In addition to their toxic foliage and honey, some members of the family Ericaceae are allelopathic. In particular, ericaceous species associated with heathland conditions seem to be responsible for slowing conifer regeneration and growth. In the boreal forests of North America, members of the genera *Gaultheria*, *Kalmia*, *Ledum*, and *Vaccinium* dominate cutover areas and poor-quality sites, with the aggressive northern sheep laurel (*Kalmia angustifolia* var. *angustifolia*) dominating extensive areas of eastern Canada and northern New England. Following disturbances such as logging and fire, sheep laurel spreads rapidly by rhizomes, impeding the successful regeneration of commercial softwood species, especially black spruce, *Picea mariana*. On these sites, black spruce as well as some other conifers have extremely low germination rates, and their seedlings exhibit nutrient deficiency symptoms and slow growth. This is a serious economic problem that has been intensively researched by Canadian foresters in an effort to develop sound ecological means to re-establish the black spruce stands (Titus et al. 1995).

In 1990 Louise de Montigny and Gordon Weetman reported that ericaceous plants, including sheep laurel, have been found to be associated with water-soluble phenolic compounds that are phytotoxic. These compounds hinder primary root development and prevent mycorrhizal inoculation of black spruce by destroying root epidermal and cortical cells. Sheep laurel is also more efficient than black spruce at accumulating soil nutrients, particularly nitrogen, and the leaves are slow to decay, increasing the amount of humus on a site. This increase in humus, the lack of nutrients, and the allelopathic effects of the phenolic compounds effectively slow regeneration of black spruce."

Photos from Bus tour by Susan Lightburn

Al & Liz Murray Garden





McKay Garden by Susan Lightburn

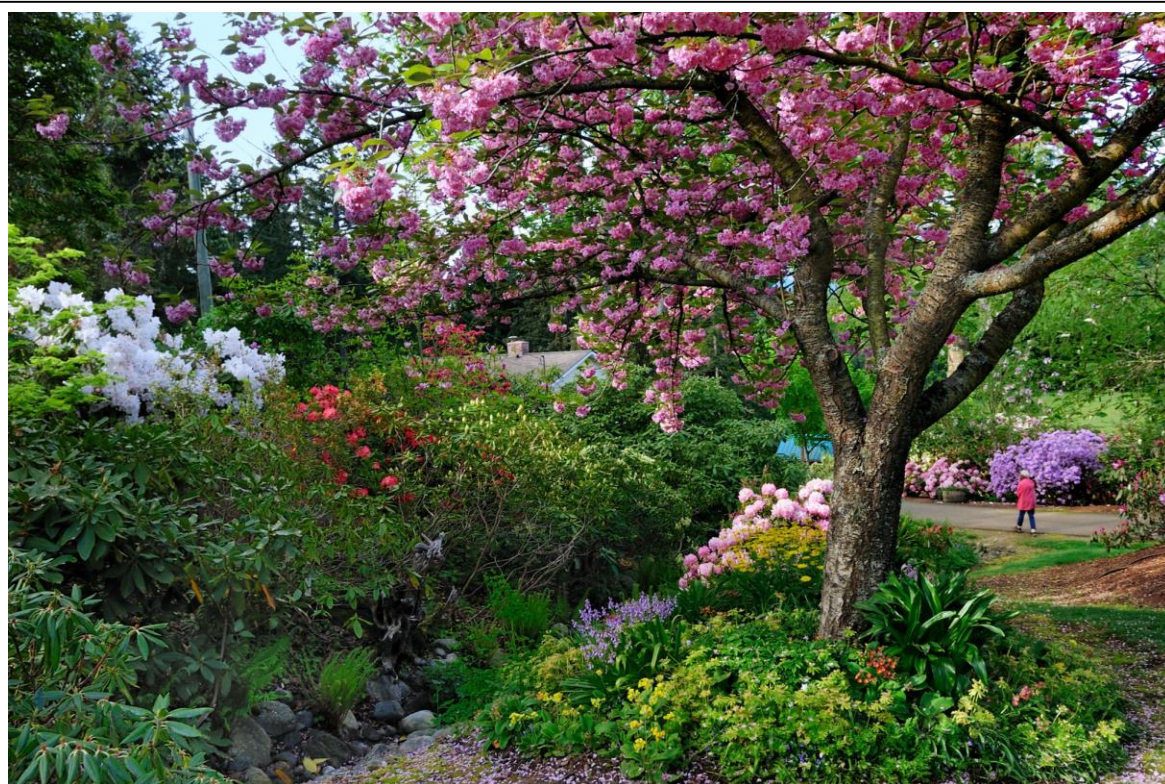

Al & Liz Murray Garden by Susan Lightburn

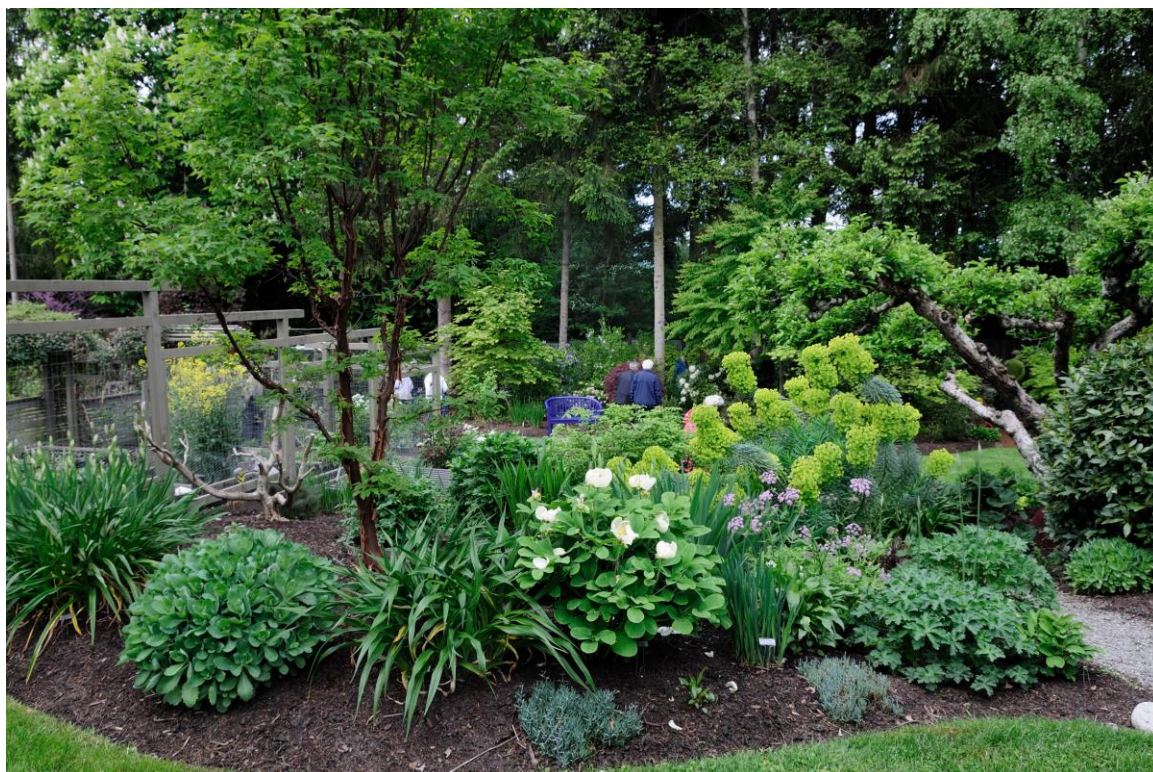

Harris Garden by Susan Lightburn

Changes at the American Rhododendron Society Office

The big news was that our Executive Director, Laura Grant, has officially retired after serving 12 years.

Katherine Sterner is our new **Office Administrator**.

. She's based in Great River, NY, lives on farm and has oodles of experience with non-profits. Her duties will be membership issues (including renewal cheques) and chapter support.

She can be reached at member@arsoffice.org, phone 631-533-0375.

Katherine Sterner, Office Administrator

P. O. Box 214, Great River, NY 11739

Phone: 631-533-0375 Fax: 866-883-8019

E-mail: member@arsoffice.org

Sterner earned a BA in Anthropology and Sociology from Mount Holyoke College in South Hadley, MA, and a Human Resources Certificate from Molloy College.



Assistant Editor Sonja Nelson is now taking care of all JARS support including missed or damaged copies. E-mail: sonjan@wavecable.com, phone 360-757-6957. ARS

Treasurer Dave Banks will be responsible for all bills and payments other than membership checks. Contact Dave for details at arstreasurer1@gmail.com, phone 757-258-8632.

NANAIMO RHODODENDRON SOCIETY

Open gardens photos by Rosina Schmidt



Art & Susan Lightburn



Ann Beamish



Dick Beamish

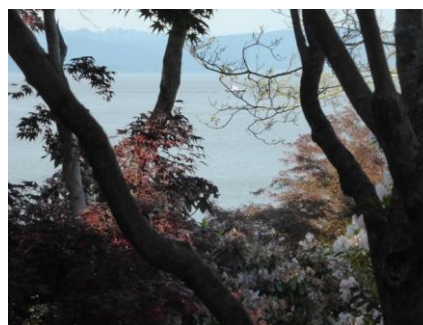

Gayle & Allen McRae



Chris with Yvonne



Robert Nixon with guests



Doug Kitts





Yvonne with Lillian Peters

Stan Peters

Seen in Passing by Susan & Art Lightburn

This year blooms on Etta Burrows, Faggetter's Favourite and Yellow Petticoats lasting much longer than average.

The growth rate on our potted tomatoes increasing just before they need water - go figure.

Rhododendrons worth growing

By Susan & Art Lightburn

Spinuliferum

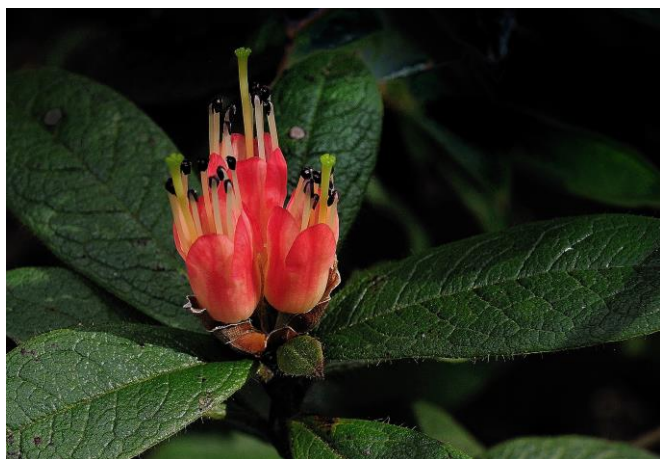

Rhododendron 'Winter Spice' — ('Hachmann's Charmant' x 'Dreamland') 5', -17°C, M, 4/4. A soft pink to white with an attractive twin red flare. Good foliage and nice habit.



Azalea 'Wedding Bouquet'

Rhododendron spinuliferum — (RN, rn, Scabrifolia) 4', -20°C

This unusual species has terrific heavily veined or puckered leaves. The leaves are a great contrast to the lightly hairy undersides and hairy stems. The orange flowers are tubular with protruding stamens and style. Like a fistful of firecrackers these flowers are held upright in the truss. A very interesting plant, a conversation piece!

Winter Spice

